

ARFF10-11-23: Teeter approaches

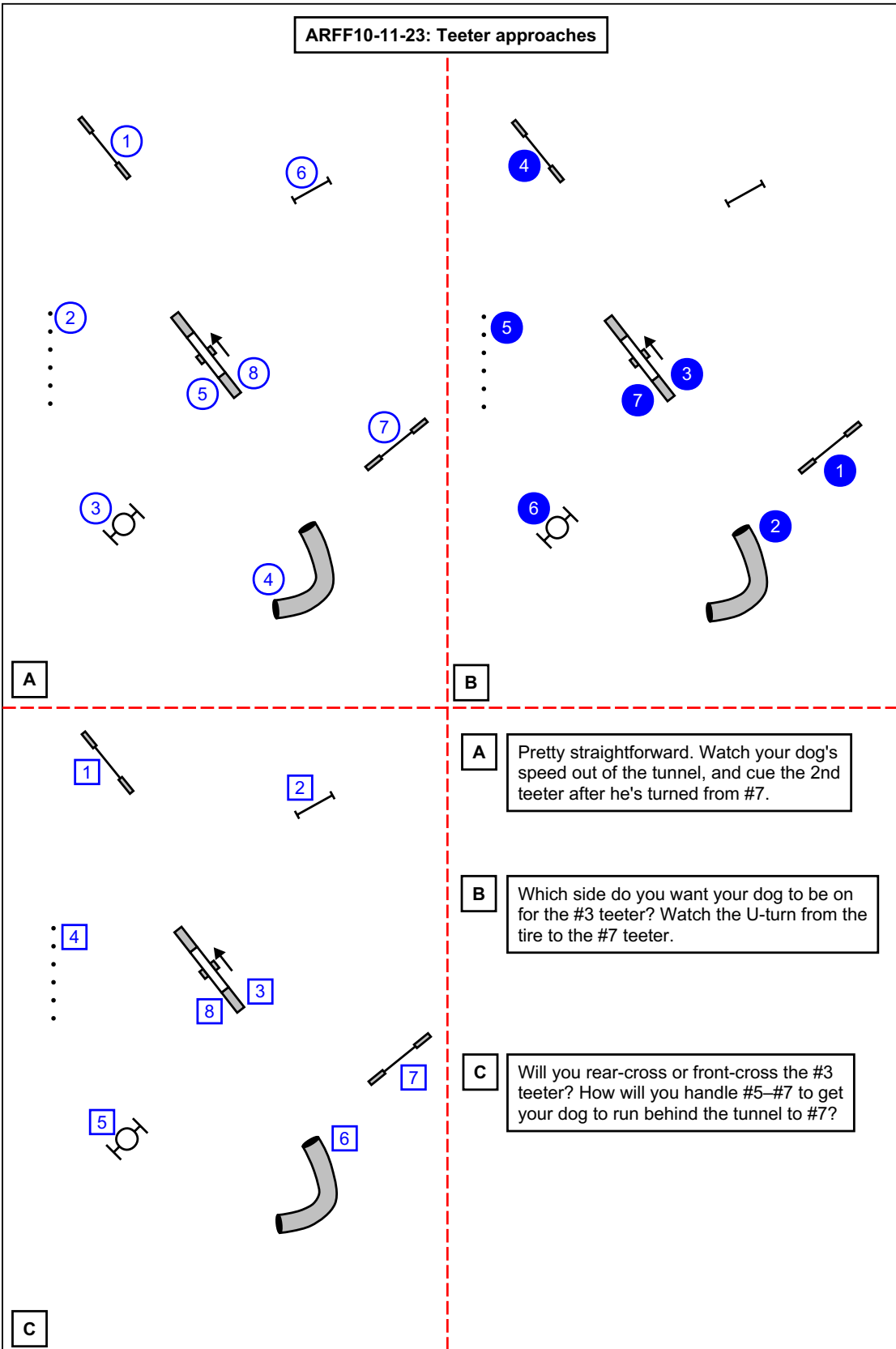

A

B

C

A Pretty straightforward. Watch your dog's speed out of the tunnel, and cue the 2nd teeter after he's turned from #7.

B Which side do you want your dog to be on for the #3 teeter? Watch the U-turn from the tire to the #7 teeter.

C Will you rear-cross or front-cross the #3 teeter? How will you handle #5-#7 to get your dog to run behind the tunnel to #7?